



marantz®

Network Receiver M-CR510

Quick Setup Guide

Start Here
Commencez ici
Iniciar aquí



Before you begin

What's In The Box



M-CR510



Power cord

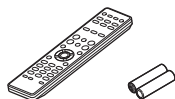

Remote and batteries



Product manual
on CD-ROM

Required For Setup

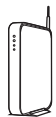

Network router

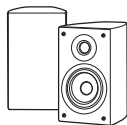

Speakers



Speaker cables

Optional

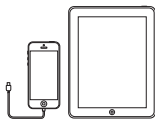

iOS device and
USB cable



Router with WPS



Network cable

* For detailed instructions or assistance, please refer to the enclosed CD-ROM manual or visit our support site: www.marantz.com

1. Connection

- 1** Connect the left and right speakers to the M-CR510

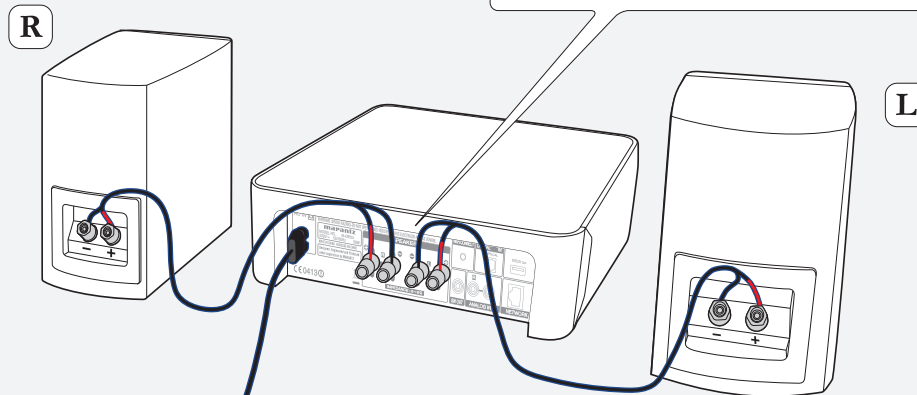

- 2** Connect the power cord from the M-CR510 to a power outlet

- 3** Insert the batteries into the remote

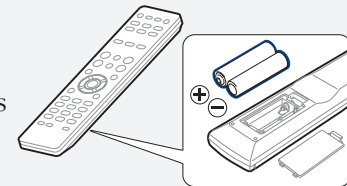

2. Connecting to your home network

Choose from one of the following options

Wireless

iOS device + USB cable

- 1 Power on
- 2 Select language
- 3 Make sure your iOS device is already connected to your WiFi Network then connect your iOS device to the front using your USB cable.
Note: You must be running iOS version 5 or later

No WPS router

- 1 Power on
- 2 Select language
- 3 Auto scan
Please wait as your M-CR510 looks for available networks...

WPS router

- 1 Power on
- 2 Select language
- 3 Press the WPS button on your router

Wired

- 1 Connect a network cable between your M-CR510 and your router (cable not included)
- 2 Power on

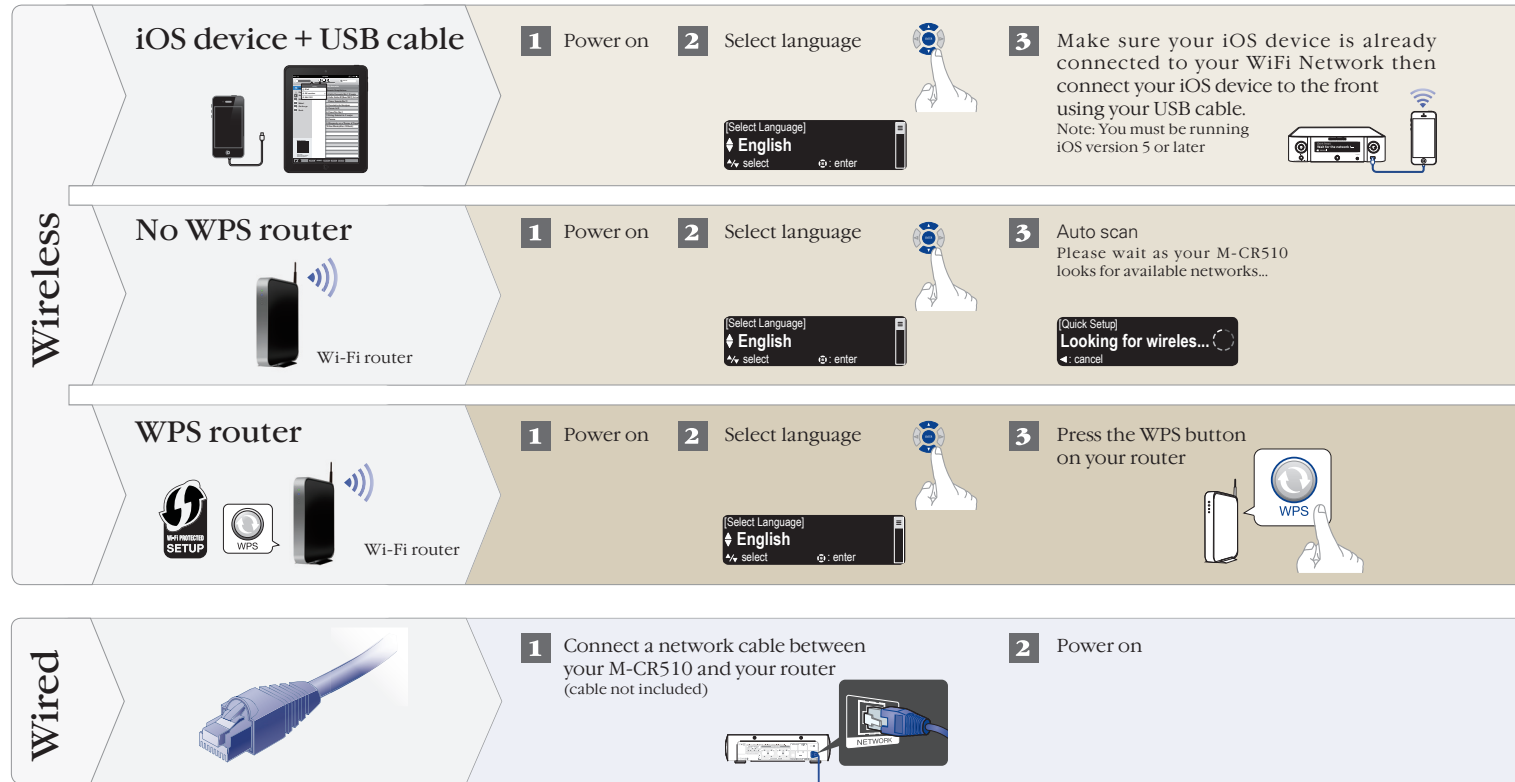

4 Press the red Wi-Fi CONNECT Button on the back of your M-CR510

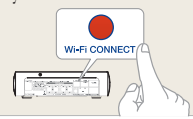

5 This message will appear on your iOS device
Select "Allow"



Connected!

Network Control

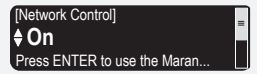

Select Network Control ON to control M-CR510 from your smartphone, use Apple AirPlay® and maintain constant network access. Power Consumption during standby power will be slightly higher.

4 Select your network name
If your network name is not listed, select "Rescan"



5 Enter your network password using the number keys on the remote control



Connected!

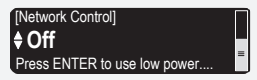

Select Network Control OFF to reduce power consumption during standby. You can not turn on your M-CR510 from your smartphone or use Apple AirPlay until your M-CR510 is powered on manually and connects to your network.

4 Within 2 minutes, Press and Hold the red Wi-Fi CONNECT button on the back of your M-CR510 for 3 seconds



5 Please wait as completing the connection can take a few minutes
The front panel of the M-CR510 will show the status of the connection

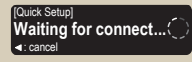

Connected!

3 Select language

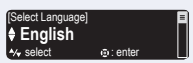

4 Please wait while your M-CR510 connects to your wired network

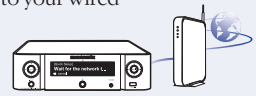

Connected!

Setup Complete!

3. Enjoying your music!

Enjoying Internet radio

- 1 Press the “INTERNET RADIO” button on the remote

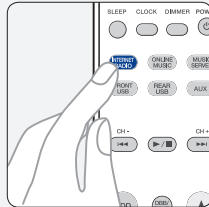

- 2 Select a station

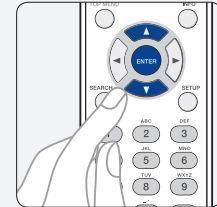

Enjoying music using Apple AirPlay

- 1 Tap the AirPlay Icon from within any app that supports AirPlay



- 2 Select the “Marantz M-CR510” from the AirPlay Device list



Note: Make sure your iOS device is on the same network as the M-CR510

Download the Marantz Remote App

Scan the QR code to download and install the Marantz Remote App using your smartphone and a scanning app or manually search the Apple App store or Google Play store for the “Marantz Remote App”



www.marantz.com

You can find your nearest authorized distributor or dealer on our website.

marantz[®] is a registered trademark.