

marantz®

Model ES7001 User Guide

Home Theater System

WARRANTY

For warranty information, contact your local Marantz distributor.

RETAIN YOUR PURCHASE RECEIPT

Your purchase receipt is your permanent record of valuable purchase. It should be kept in a safe place to be referred to as necessary for insurance purposes or when corresponding with Marantz.

IMPORTANT

When seeking warranty service, it is the responsibility of the consumer to establish proof and date of purchase. Your purchase receipt or invoice is adequate for such proof.

FOR U.K. ONLY

This undertaking is in addition to a consumer's statutory rights and does not affect those rights in any way.

WARNINGS

- Do not expose the equipment to rain or moisture.
- Do not remove the cover from the equipment.
- Do not insert anything into the equipment through the ventilation holes.
- Do not handle the mains cord with wet hands.
- Do not cover the ventilation with any items such as tablecloths, newspapers, curtains, etc.
- No naked flame sources, such as lighted candles, should be placed on the equipment.
- When disposing of used batteries, please comply with governmental regulations or environmental public instruction's rules that apply in your country or area.
- No objects filled with liquids, such as vases, shall be placed on the equipment.
- When the switch is in the OFF position, the equipment is not completely switched off from MAINS.
- The equipment shall be installed near the power supply so that the power supply is easily accessible.

保修

关于保修信息, 请与您当地的Marantz批发商联络。

保留您的购买收据

您的购买收据是您有价购买的永久记录。应当将它保存在安全的地方, 需要时可作为保险或与Marantz沟通时的凭证。

重要事项

当需要保修服务时, 消费者有责任提供购买的凭证及日期。您的购买收据或发票即可作为充分的凭证。

只适用于英国

这一承诺作为消费者法定权利的补充, 不能以任何方式改变这些法定权利。

警告

- 不要让本器材暴露于雨水或湿气之中。
- 不要移除本器材的外盖。
- 不要从通风孔将任何物品推入本器材内。
- 不要用潮湿的手处理主电源电线。
- 不要使诸如桌布、报纸、窗帘等任何物品遮盖住通风口。
- 不要将诸如点燃的蜡烛等明火火源置于本器材上。
- 当丢弃废旧的电池之前, 请遵守当地的政府法规及环境保护规则。
- 切勿将盛有液体的物品, 如花瓶, 置于本机上。
- 当开关位于OFF处时, 本设备并未完全与MAINS切断。
- 本设备应安装在电源附近, 以方便接上电源。

「根据电子信息产品污染控制管理办法的有毒·有害物质或元素的标识表」

零部件名称	对象零部件	有毒有害物质或元素						备注
		铅 (Pb)	汞 (Hg)	镉 (Cd)	六价铬 (Cr6+)	多溴联苯 (PBB)	多溴二苯醚 (PBDE)	
电路板	电路板组件, 安装·插入零部件, 电路板 (不包括特定电子零部件)	×	○	×	○	○	○	
机壳	顶盖, 底盖, 底壳, 框架, 垫片, 螺丝等 (金属, 塑胶), (包含的接合材料)	×	○	○	○	○	○	
特定电子零部件	变压器, 插入物, 电源插座, 电源用大型电解质电容器等电子零部件, 机内连结线	×	○	○	○	○	○	
附件	遥控器 /AC 适配器、电源线、RCA 信号线等附件, 包装	×	○	○	○	○	○	
备注: ○: 在该零部件的所有物质材料中的有毒有害物质的含量不超过在 SJ/T11363-2006 标准规定的限量要求 ×: 在该零部件中至少一种物质材料中的有毒有害物质的含量超过在 SJ/T11363-2006 标准规定的限量要求 (× 判定: 包括 EU RoHS 的豁免项目)								



此标志是根据 2006/2/28 颁布的「电子信息产品污染控制管理办法」, 以及「电子信息产品污染控制标识要求」, 适用于在中国销售的电子信息产品的环保使用期限。只要遵守此产品相关的安全和使用注意事项, 在从生产日期起计算的此年限内, 产品中的有害物质不会往外泄漏, 或者引起突然变异而给环境污染, 人体或财产带来重大影响。另外, 包装在一起的电池等消耗品的环保期限的技术寿命为 5 年。产品使用终结需废弃时, 请遵守当地的电子信息产品回收·再利用相关的法律·规定。

Thank you for purchasing the Marantz Home Theater System.

Before using this unit, please read the User Guide carefully to ensure proper operation of the unit, and retain it together with the supplied warranty.

■ Accessories Check

Before use, check the below accessories were included in the package.

- Remote controller

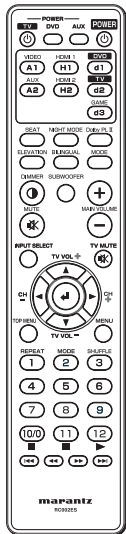

- AAA-size batteries x 2

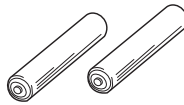

- User Guide (This manual)

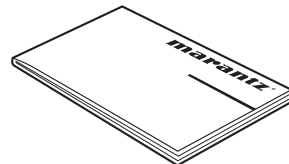

CONTENTS

FEATURES 2

BEFORE USING THIS UNIT 3

NAMES AND FUNCTIONS OF PARTS 5

 FRONT PANEL 5

 REAR PANEL 6

 REMOTE CONTROLLER: RC002ES 7

CONNECTIONS 12

 CONNECTING DIGITAL EQUIPMENT WITH THE OPTICAL CONNECTOR.... 12

 CONNECTING ANALOG EQUIPMENT 13

 CONNECTING DIGITAL EQUIPMENT EQUIPPED WITH THE HDMI CONNECTOR..... 13

 CONNECTING A SUBWOOFER..... 14

 REMOTE CONTROL CONNECTIONS 14

INSTALLATION..... 15

BASIC OPERATIONS 16

 TURNING ON THE UNIT..... 16

 PLAYING THE INPUT SOURCE 16

SETTINGS 17

 SETTING INSTALLATION HEIGHT OF SPEAKERS..... 17

 SETTING THE NUMBER OF AUDIENCE 17

 SETTING THE VIEWING/LISTENING DISTANCE 18

 SETTING THE SUBWOOFER OUTPUT..... 18

 SETTING THE BINAURAL MODE 19

 SETTING THE DOLBY PRO LOGIC II MODE..... 19

 SETTING MULTI-CHANNEL TV SOUND MODE..... 20

 SETTING THE NIGHT MODE 20

 SETTING THE DIMMER..... 20

 RESETTING ITEMS TO FACTORY PRESET SETTINGS..... 21

TROUBLESHOOTING 21

SPECIFICATIONS 22

OTHERS 22

FEATURES

[MAIN FUNCTION]

● What is OPSODIS?

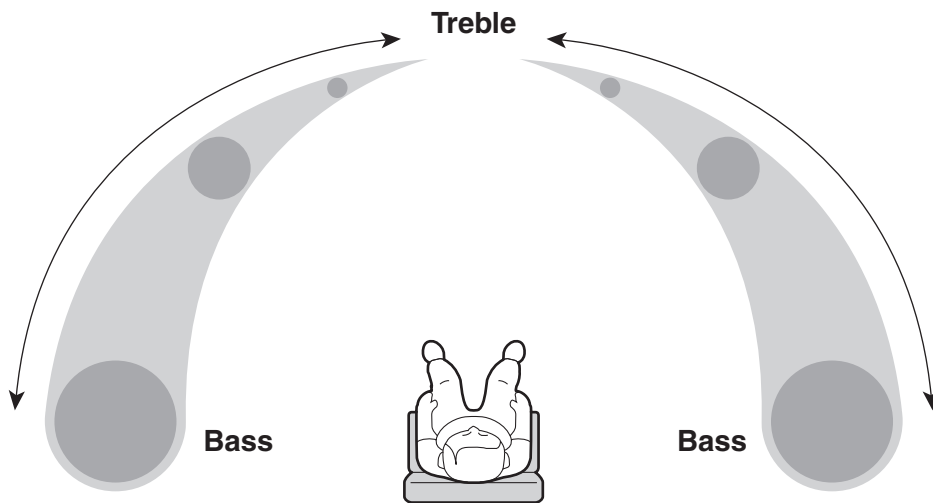

OPSODIS (Optimal Source Distribution) is a new virtual surround technology developed by the Institute of Sound and Vibration Research (ISVR) and Kajima Corporation. OPSODIS technology has been united with Marantz's high-quality sound technology to realize a superior surround environment than ever before.

The ES7001 realizes reproduction of omni-directional sound only with the speakers built in this unit.

The ES7001 releases listeners from the conventional surround environment that has required complex installation of five or more speakers. As a result, installing the AV system in a room has little effect on their lifestyle or living environment.

[DIGITAL AMPLIFIER SECTION]

The unit incorporates a 6-channel digital power amplifier, allowing direct drive of the speakers' tweeter, midrange and woofer.

The digital audio signals are input to the digital amplifier of the unit through the optical digital and the HDMI connectors without digital-analog conversion.

[PWM PROCESSOR SECTION]

Using digital filters for cutoff frequency of the 6 channel digital power amplifier enables extreme filter precision that cannot be achieved with conventional analog filters, providing the OPSODIS effects more efficiently.

[POWER SUPPLY SECTION]

The R-core transformer is adopted for the power supply section of this unit. Thanks to the features of the R-core transformer—less leakage magnetic flux, less heat generation and quick response to overload variation—the unit produces a high quality and powerful sound.

[CABINET]

Adoption of high-rigidity aluminum for the cabinet of the unit provides a sophisticated stiff construction, allowing reproduction of beautiful crystalline sound.

[OTHER FEATURES]

- The OPT IN and HDMI IN connectors are compatible with Dolby Digital 5.1ch, dts and AAC audio inputs.
- Supports Dolby PL II feature for 2-channel signal input and for digital signal input.
- Binaural recording* sources can be reproduced through the front speaker.
 - * Binaural recording is a method of recording audio which uses two microphones mounted in the ears of a dummy head in the shape of the human head and ears.
 - Binaural recording can reproduce location of sound behind, ahead, above and below. It makes you feel a real sense of distance.
 - Normally, a dramatic binaural effect can be achieved only with headphones.
 - However, a similar or more stereophonic effect can be achieved by playback of a binaural recording source using this unit than that with headphones.
- The newest 32 bit DSP circuits adopted (one for decoding of Dolby, dts, ACC and PCM, and two dedicated for OPSODIS circuits)

FEATURES

● **DOLBY**



Manufactured under license from Dolby Laboratories. “Dolby”, “Pro Logic”, the double-D symbol and “AAC” are trademarks of Dolby Laboratories.

● **AAC**



AAC is a format of the MPEG2 standard. This features excellent high-compression encoding and high-quality sound, enabling reproduction of 2-channel stereo sound and 5.1-channel surround, and bilingual broadcast. The following is the patent numbers of this format.

5848391	5,291,557	5,451,954
5 400 433	5,222,189	5,357,594
5 752 225	5,394,473	5,583,962
5,274,740	5,633,981	5 297 236
4,914,701	5,235,671	07/640,550
5,579,430	08/678,666	98/03037
97/02875	97/02874	98/03036
5,227,788	5,285,498	5,481,614
5,592,584	5,781,888	08/039,478
08/211,547	5,703,999	08/557,046
08/894,844	5,299,238	5,299,239
5,299,240	5,197,087	5,490,170
5,264,846	5,268,685	5,375,189
5,581,654	5,548,574	5,717,821
08/937,950	05-183,988	08/506,729
08/576,495	08/392,756	

● **dts**



Manufactured under license under U.S. Patent #'s: 5,451,942; 5,956,674; 5,974,380; 5,978,762; 6,487,535 & other U.S. and worldwide patents issued & pending. DTS is a registered trademark and the DTS logos, Symbol and DTS Virtual are trademarks of DTS, Inc. © 1996-2007 DTS, Inc. All Rights Reserved.

● **OPSODIS**



OPSODIS is a registered trademark of the OPSODIS LTD.

● **HDMI**



HDMI, the **HDMI** and High-Definition Multimedia Interface are trademarks or registered trademarks of HDMI Licensing LLC.

BEFORE USING THIS UNIT

This section must be read before any connection is made to the mains supply.

■ **Equipment mains working setting**

Your Marantz product has been prepared to comply with the household power and safety requirements that exist in your area. This unit can be powered by 220V AC only.

■ **Copyright**

Recording and playback of any material may require consent. For further information refer to the following:

- Copyright Act 1956
- Dramatic and Musical Performers Act 1958
- Performers Protection Acts 1963 and 1972
- Any subsequent statutory enactments and orders

■ **Do Not Locate in the Following Places**

To ensure long-lasting use, do not locate the unit where:

- Exposed to direct sunlight.
- Near to sources of heat such as heaters.
- Highly humid or poorly ventilated.
- Dusty.
- Subjected to mechanical vibrations.
- On wobbly, inclined or otherwise unstable surfaces
- On a high place such as on a TV set

The ventilation holes are located at the rear of the unit. To ensure proper heat radiation, ensure the below clearance from walls and other equipment.

■ **Keep Objects Off**

Keep objects off the unit.

■ **Do not touch hot spots during and immediately after use**

During and immediately after use, the unit is hot in areas other than the controls and rear panel connection jacks. Do not touch hot spots and especially the rear panel. Contact with hot areas can cause burns.

■ **Cautions on handling power cord**

- Do not touch the power cord with wet hands.
- When disconnecting the power cord, always make sure that you take hold of the plug. Yanking out or bending the cord can damage it and/or cause electric shocks or a fire.
- Get into the habit of disconnecting the power plug before leaving home.

BEFORE USING THIS UNIT

■ For use of Remote controller

● Loading batteries

Before using the remote controller for the first time, load the batteries in the remote controller. The batteries provided are used to verify the operations of the remote controller only.

- ① Remove the battery cover.

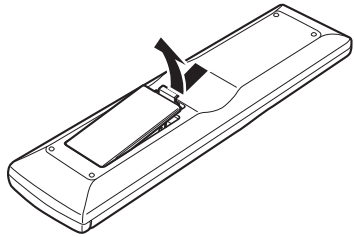

- ② Insert the batteries with correct +/- orientation.

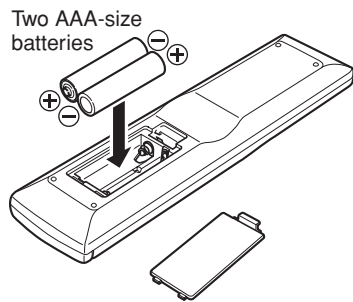

- ③ Close the battery cover until it clicks shut.

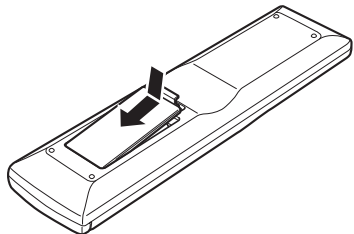

● Cautions on handling batteries

Misuse of the batteries can result in electrolyte leakage, rupturing, corrosion, etc. Bear in mind the following points when using batteries.

- Remove the batteries from the remote controller if the unit is not going to be used for a prolonged period (a month or more).
- Do not use an old battery together with a new one.
- Insert the batteries while ensuring that their \oplus and \ominus poles are properly aligned with the corresponding markings on the remote controller.
- Batteries with the same shape may have different voltages. Do not use different types of batteries together.
- If electrolyte has leaked, thoroughly wipe the inside of the battery compartment, and then insert new batteries.
- When batteries which are no longer required are to be discarded, follow the directions (regulations) laid down by the local authorities in the area concerned for their disposal.

● Operatable range of Remote controller

Operate the unit with the remote controller within the range of the illustration below.

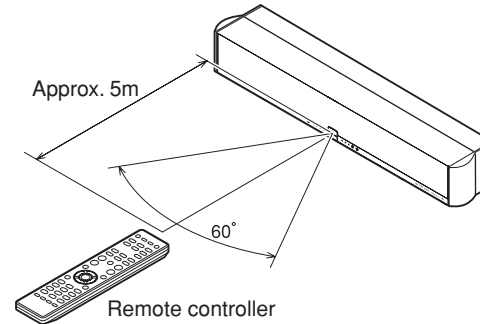
**Cautions:**

- Do not allow direct sunlight, an inverter fluorescent light or other strong source of light to shine onto the player's infrared receptor window. Otherwise, the operation of the remote controller may be disabled.
- Bear in mind that operating the remote controller may cause other devices operated by infrared rays to be operated by mistake.
- The remote controller cannot be operated if the space between the controller and the player's infrared receptor window is obstructed.
- Do not place any objects on top of the remote controller. Doing so may cause one or more buttons to be held down which will cause the batteries to run down.

NAMES AND FUNCTIONS OF PARTS

REAR PANEL

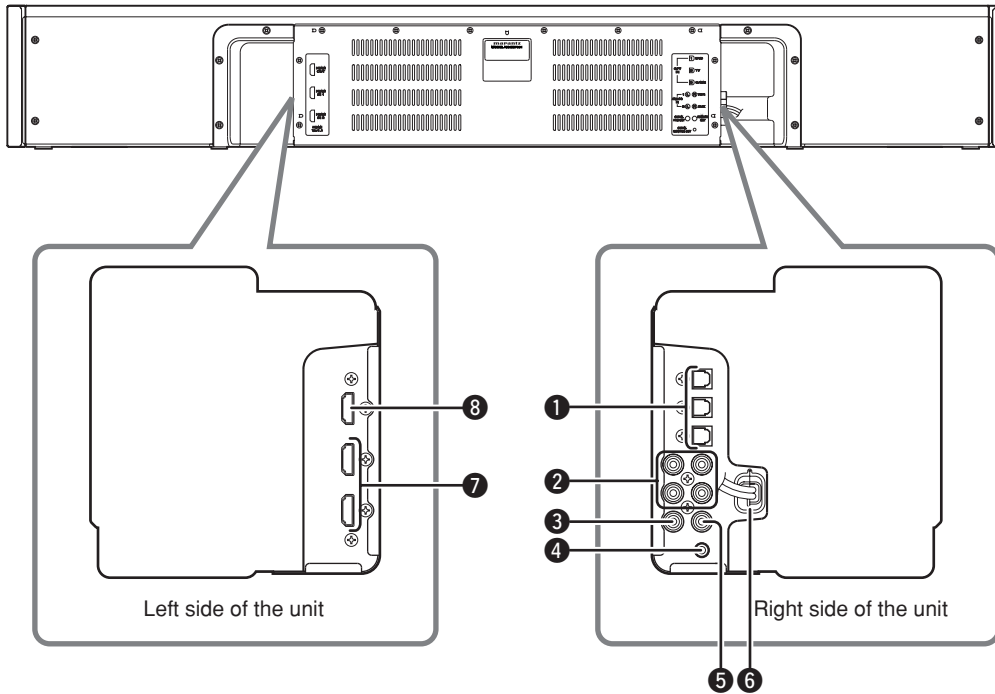

1 OPT IN 1 (DVD)/2 (TV)/3 (GAME) connectors

These connectors are used to connect to the optical digital output connectors on a DVD player, TV, video game console, etc.

- Connect a DVD player to the OPT IN 1 connector.
- Connect a TV to the OPT IN 2 connector.
- Connect a video game console to the OPT IN 3 connector.

Note:

When “d1”, “d2” or “d3” is selected with the INPUT SELECTOR button on the unit and no signal is input from the connected equipment for five minutes, the unit automatically goes into standby mode.

2 ANALOG IN 1 (VCR)/2 (AUX) jacks

These jacks are used to connect to the analog output jacks on a VCR and external player.

- Connect a VCR to the ANALOG IN 1 jacks. To select the input, press the A1 button on the remote controller.
- Connect an external player to the ANALOG IN 2 jacks. To select the input, press the A2 button on the remote controller.

3 SUB W. PREOUT jack

This jack is used to connect to the input jack of an external subwoofer with a built-in amplifier.

4 SUB W. CONTROL OUT jack

This jack is used to connect to the CONTROL IN jack of the optional Marantz SW7001 subwoofer with built-in amplifier. The connected subwoofer is turned on or goes into standby mode in conjunction with the operations of the unit.

Note:

To use the control function, turn on the power of the subwoofer.

5 REMOTE OUT jack

This jack is used to connect other Marantz equipment such as a DVD player equipped with remote control jack.

Note:

When the Marantz DVD player or the IS201 iPod universal dock is located in a place where the infrared beam cannot be easily received, make a remote control connection. If you operate the remote controller pointed toward this unit, a received command signal is transmitted to the connected equipment.

6 AC power cord

Connect the cord to the wall outlet.

7 HDMI IN 1/2 connectors

These connectors are used to connect to the HDMI output of a hard disk recorder, TV tuner, video game console, etc. The HDMI IN/OUT connectors on the unit are compatible with Version 1.1.

8 HDMI OUT connector

This connector is used to connect to the HDMI input of a TV, video projector, etc. The HDMI IN/OUT connectors on the unit are compatible with Version 1.1.

NAMES AND FUNCTIONS OF PARTS

REMOTE CONTROLLER: RC002ES

Buttons used for this unit

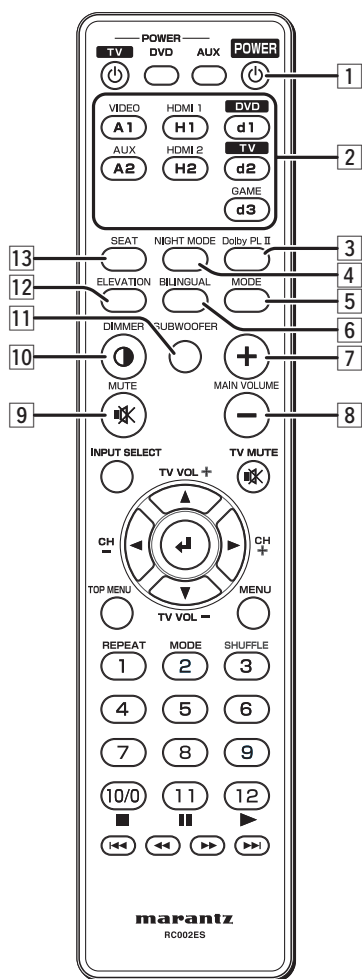

1 POWER button

Press this button to turn on the unit or to set it to standby mode.

2 Input select buttons

These buttons are used to select the input source to be played.

Press the input source button you want to play.

3 Dolby PL II button

Press this button to switch the Dolby Pro Logic II sound field environment. Each press switches among Pro Logic II MOVIE, Pro Logic II MUSIC and OFF.

Note:

This button functions when the analog input signal or 2-ch PCM input signal is selected.

4 NIGHT MODE button

Press this button when you want to lower the volume of the source for cases such as movie viewing at night.

As the enhanced parts of the reproduced sound are suppressed in this mode, you can enjoy the sound without elevating the entire volume.

5 MODE button

Press this button to listen to the binaural recording source.

6 BILINGUAL button

Press this button to switch the bilingual sound output from the TV when the unit receives a high-definition TV broadcast (AAC audio signal).

7 MAIN VOLUME + button

Press this button to increase the volume of the unit.

8 MAIN VOLUME – button

Press this button to decrease the volume of the unit.

9 MUTE button

Press this button to mute the sound temporarily. Press it again to restore the sound.

10 DIMMER button

Press this button to dim the display window.

11 SUBWOOFER button

This button is used to activate a commercially available or the Marantz SW7001 subwoofer with a built-in amplifier connected to the unit.

Note:

This function is activated at the factory. When no subwoofer is connected to the unit, press this button to turn off the indicator.

12 ELEVATION button

Press this button to switch the height of the unit installation position. "L" (lower than the TV position) or "H" (higher than the TV position) can be selected.

13 SEAT button

[For number of audience]

Press this button once to switch the number of the audience between "1P" (one person) and "2P" (two or more persons).

[For the viewing/listening distance]

Hold down this button for over 2 seconds to switch the distance between the audience and the unit from among "2 m or shorter," "Approx. 2 m" and "2 m or longer."

Notes:

- When the audience is 2.5 m or farther away from the unit and the viewing/listening distance is set to "2 m or longer," the stereophonic effect of the unit may be reduced.
- When the audience is close 1.5 m or less to the unit and the viewing distance is set to "2 m or shorter," the stereophonic effect of the unit may be reduced.

NAMES AND FUNCTIONS OF PARTS

Buttons used for a TV

Notes:

- Before using the remote controller for a TV, set the preset code for the TV.
- For details on the operation of the TV, refer to the instruction manual supplied with the TV.

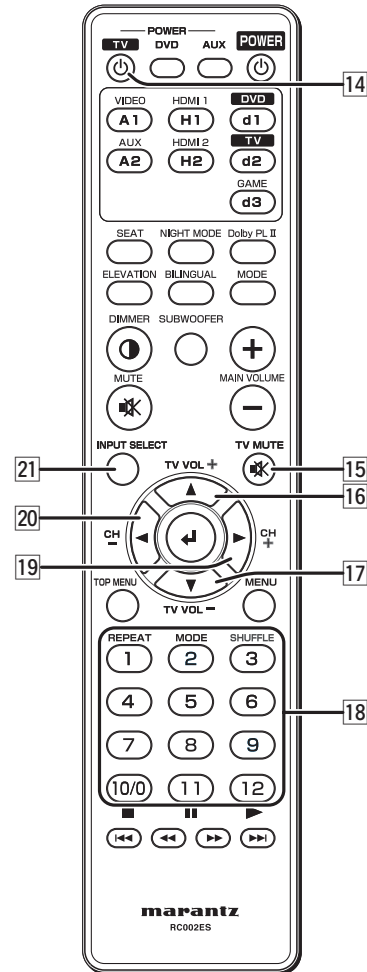

14 TV POWER button

Press this button to turn on the TV or to set it to standby mode.

15 TV MUTE button

Press this button to mute the TV sound temporarily. Press it again to restore the sound.

16 TV VOL + button

Press this button to increase the volume of the TV.

17 TV VOL – button

Press this button to decrease the volume of the TV.

18 Numeric (1-12) buttons

These buttons are used for direct TV channel selection.

19 CH (channel) + button

Press this button to scan forward through the TV channels.

20 CH (channel) - button

Press this button to scan reverse through the TV channels.

21 INPUT SELECT button

Press this button to switch between the TV broadcast and a video input.

Preset code setting

The remote control codes of TVs of manufacturers other than Marantz are preset in the supplied remote controller. To use the supplied remote controller for the TV of another manufacturer, enter the code in the remote controller.

1. Check the four-digit code number of your TV manufacturer in the preset code number lists shown below.
2. While holding down the TV POWER button **14** on the remote controller, press the Numeric buttons **18** to enter the four-digit manufacturer's code number.
Presetting the code number to the remote controller is complete.

Notes:

- Some of the preset codes in the lists may not be compatible with your TV.
- If your TV does not operate with the remote controller after entering the preset code, try to enter another code number of the manufacturer.
- Some of the functions of the TV may not be operable with the remote controller even after entering the code.

NAMES AND FUNCTIONS OF PARTS

■ TV preset code number lists

Acer	1141	Goldstar	1003, 1013, 1024	Portland	1003, 1013, 1024, 1059	Telecaption	1074
Admiral	1002, 1009, 1089		1030, 1045, 1080	Price Club	1026	Toshiba	1003, 1019, 1025
Aiko	1059		1100, 1112, 1154	Prism	1018		1026, 1042, 1074, 1098
Aiwa	1117, 1118	Hallmark	1003	Proscan	1004, 1005, 1006, 1007		1107, 1111, 1135, 1136
Akai	1001	Hisense	1116		1008, 1085, 1103, 1110	Totevision	1013
Amtron	1023	Hitachi	1003, 1012, 1031, 1032	Proton	1003, 1045	Universal	1046, 1054
Anam	1113		1037, 1041, 1045, 1047	Quasar	1010, 1069, 1073, 1111, 1153	Video Concepts	1113
Anam National	1023, 1069, 1092		1065, 1068, 1082, 1088	Radio Shack	1003, 1013, 1015,	Viewsonic	1006, 1022, 1109
AOC	1003, 1024, 1049, 1127		1094, 1139, 1140, 1145, 1159		1023, 1024, 1025, 1045		1128, 1129, 1130, 1131
Audiovox	1023	Infinity	1067		1100, 1103, 1110, 1113		1138, 1143, 1145, 1150
Bell & Howell	1009, 1025	Janeil	1134	RCA	1003, 1004, 1005	Wards	1003, 1009, 1015
Benq	1104, 1142	JBL	1067		1006, 1007, 1008		1024, 1038, 1044, 1046
Broksonic	1003, 1097, 1098, 1113	JC Penney	1003, 1013, 1018		1014, 1024, 1049, 1069		1052, 1054, 1056, 1057
Celebrity	1001		1019, 1024, 1026		1075, 1079, 1085, 1087		1067, 1086, 1103, 1110
Citizen	1003, 1013, 1023		1046, 1047, 1054		1088, 1093, 1094, 1101	White Westinghouse	1101, 1001
	1026, 1059, 1063		1063, 1083, 1085		1103, 1110, 1113, 1153	Yamaha	1003, 1024
Colortyme	1003, 1043		1100, 1103, 1110	Realistic	1013, 1015, 1023, 1025	Zenith	1003, 1009, 1010
Contec	1113		1112, 1133, 1154		1045, 1100, 1103, 1110		1132, 1144, 1153
Contec/Cony	1023, 1045, 1047	Jensen	1003	Runco	1010, 1153		
Craig	1020, 1022, 1023, 1113	JVC	1028, 1029, 1045	Sampo	1150		
Crown	1023, 1067		1047, 1050, 1060, 1065	Samsung	1003, 1013, 1024, 1026		
Curtis Mathes	1003, 1013, 1025	Kawasho	1001, 1003		1040, 1045, 1062, 1078		
	1026, 1062, 1103, 1110	Kenwood	1003		1083, 1090, 1100, 1105, 1114		
Daewoo	1003, 1013, 1024, 1035	Kloss Novabeam	1023, 1056, 1057, 1134		1120, 1121, 1146, 1148, 1157		
	1036, 1059, 1084, 1101	KTV	1013, 1023, 1033	Sansui	1119		
Daytron	1003, 1013, 1016		1034, 1073, 1099, 1113	Sanyo	1003, 1025, 1051, 1072		
Dimensia	1103, 1110	LG	1024, 1030		1077, 1091, 1156, 1157, 1158		
Dumont	1003, 1010, 1153	M.Wards	1002, 1009, 1038	Sharp	1003, 1013, 1014		
Electroband	1001	Magnavox	1003, 1052, 1053		1015, 1045, 1055, 1064		
Electrohome	1001, 1003, 1069, 1133		1056, 1057, 1063		1066, 1076, 1089, 1123		
Emerson	1003, 1013, 1015,	Marantz	1003, 1031, 1067, 1122	Signature	1009		
	1020, 1021, 1022, 1023		1003, 1024, 1051	Sony	1001, 1102, 1108		
	1025, 1038, 1044, 1045	Mitsubishi	1115, 1122, 1133	Soundesign	1003, 1023, 1038, 1063, 1113		
	1048, 1055, 1061, 1094		1014, 1069	Starlite	1023		
	1096, 1099, 1101, 1113	Motorola	1003, 1012, 1024, 1043, 1069	Supre-Macy	1134		
Envision	1003	NEC	1137, 1150	Sylvania	1003, 1039, 1042		
Fisher	1025, 1051, 1091, 1160	NET-TV	1020, 1096		1052, 1053, 1056, 1057		
Fujitsu	1038, 1124, 1125, 1155	Orion	1017, 1067, 1069, 1095, 1111		1063, 1067, 1089, 1151		
Funai	1023, 1038, 1113	Panasonic	1003, 1011, 1045, 1052	Symphonic	1023, 1039, 1044		
Gateway	1150		1054, 1056, 1057, 1058	Tandy	1014		
GE	1003, 1018, 1022, 1046	Philips	1063, 1067, 1069, 1106	Tatung	1069		
	1054, 1069, 1085, 1103		1003, 1018, 1037	Technics	1018		
	1110, 1113, 1133, 1136, 1153	Pioneer	1070, 1071, 1094	Techwood	1003, 1018		
			1145, 1147, 1149	Teknika	1003, 1009, 1013, 1023		
		Plasmsync	1135		1024, 1026, 1038, 1045		
					1047, 1059, 1063, 1111, 1113		

NAMES AND FUNCTIONS OF PARTS

■ Before using the remote controller for Marantz products

- Press the button specified for the equipment you want to operate.
 - DVD player: “d1” button on the remote controller
 - IS201: “A2” button on the remote controller
- Operate the unit using the buttons described in the respective list.

Notes:

- For details on operation, please refer to the instruction manual supplied with the connected Marantz products.
- Some models may not operate with the remote controller supplied with this unit.

■ Buttons used for a Marantz DVD player

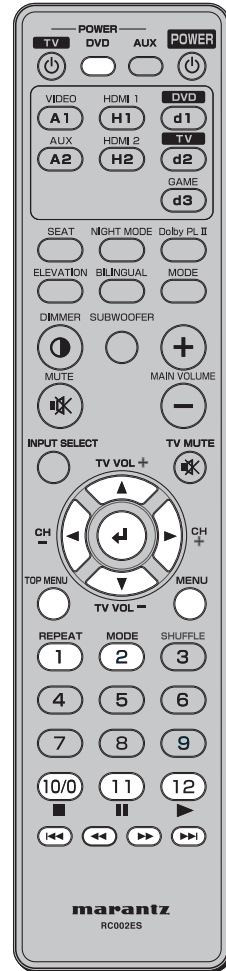

DVD POWER button	Turns on the DVD or sets it to standby mode.
▲ button	Moves the cursor up.
▼ button	Moves the cursor down.
◀ button	Moves the cursor left.
▶ button	Moves the cursor right.
↵ button	Executes the selected item.
TOP MENU button	Displays the top menu of a DVD disc.
MENU button	Displays the setting menu of a DVD player.
REPEAT button	Repeats playback of a chapter or disc.
MODE button	Selects the Super Audio CD sound mode.
■ button	Stops playback.
 button	Pauses playback.
▶ button	Starts playback.
◀◀ button	Returns to the beginning of the current music or chapter.
◀◀ button	Fast backward search
▶▶ button	Fast forward search
▶▶ button	Skips to the next music or chapter.

■ Buttons used for the Marantz IS201 iPod universal dock

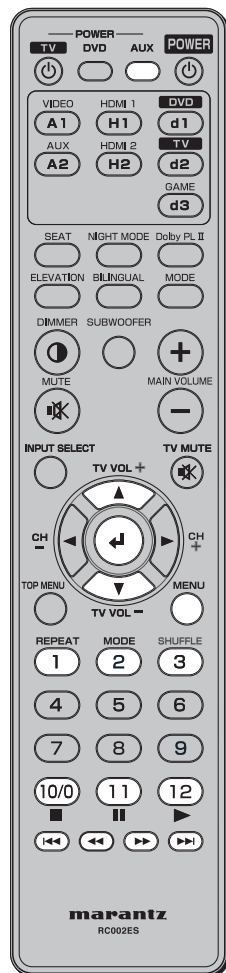

AUX POWER button	Turns on the power of an iPod connected to the IS201 or sets it to standby mode.
▲ button	Functions the same as turning the click wheel of an iPod counterclockwise. Note: The iPod volume cannot be adjusted.
▼ button	Functions the same as turning the click wheel of an iPod clockwise. Note: The iPod volume cannot be adjusted.
↶ button	Functions the same as the click wheel select button of an iPod.
MENU button	Functions the same as the click wheel menu button of an iPod.
REPEAT button	Switches the iPod repeat mode. (Track repeat → All repeat → Off)
MODE button	Switches the mode of the IS201 (OSD/LCD)
SHUFFLE button	Switches the iPod shuffle mode. (Track → Album → Off)
■ button	Stops iPod playback.
 button	Pauses iPod playback.
▶ button	Starts iPod playback.
◀◀ button	Returns to the beginning of the current content by one press. Returns to the previous content by two successive presses.
◀◀ button	Fast backward search
▶▶ button	Fast forward search
▶▶ button	Skips to the next content by one press.

CONNECTIONS

Notes:

- Do not connect the AC power cords of the unit and connected equipment to the wall outlet before making all connections.
- Insert the connecting cable plugs firmly into the connectors. A loose connection may result in noise.
- Be sure to connect the L (left) channel to the white connector, and the R (right) channel to the red connector.
- Connect the input and output connectors correctly.
- Please refer to the respective instruction manual for connected equipment.

CONNECTING DIGITAL EQUIPMENT WITH THE OPTICAL CONNECTOR

- This unit is equipped with three optical digital inputs.
- Use the commercially available optical connecting cable for connection.

■ Connections

- Connect a DVD player to the OPT IN 1 connector on the unit.

The Marantz DVD player is assigned to the d1 button on the supplied remote controller, and the basic operations of the Marantz DVD player are enabled with the remote controller.

- Connect a TV to the OPT IN 2 connector on the unit.

A TV is assigned to the d2 button on the supplied remote controller, and the basic operations of the TV are enabled with the remote controller.

- Connect a video game console to the OPT IN 3 connector on the unit.

A video game console is assigned to the d3 button on the supplied remote controller.

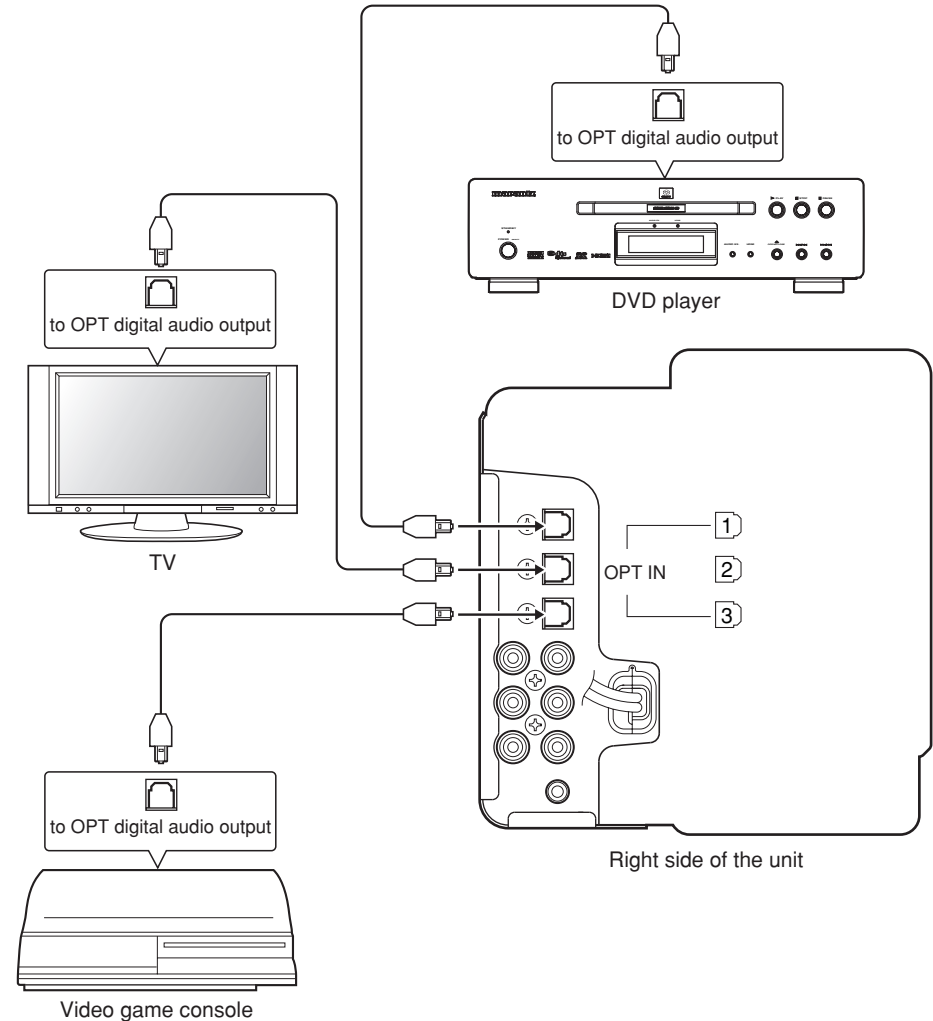

CONNECTIONS

CONNECTING ANALOG EQUIPMENT

- This unit is equipped with two analog inputs.
- Use a commercially available RCA audio cable for connection.

■ Connections

- Connect a VCR to the ANALOG IN 1 connector on the unit.
A VCR is assigned to the A1 (VIDEO) button on the supplied remote controller.
- Connect the IS201 iPod universal dock to the ANALOG IN 2 connector on the unit.
The IS201 is assigned to the A2 (AUX) button on the supplied remote controller, and the basic operations of the IS201 are enabled with the remote controller.

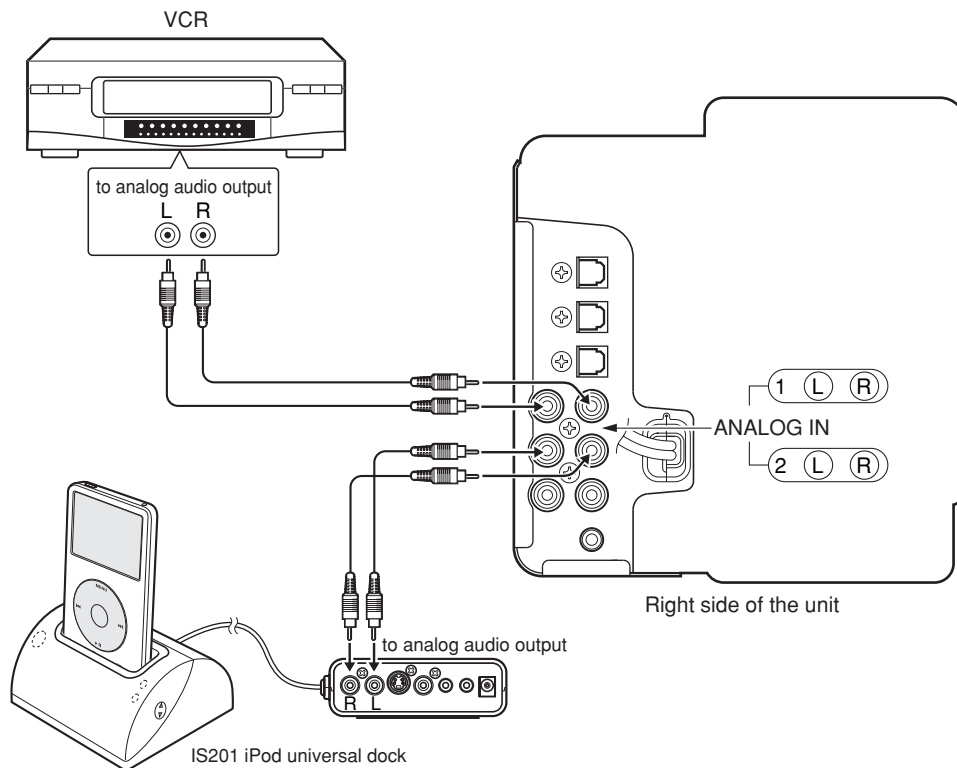

CONNECTING DIGITAL EQUIPMENT EQUIPPED WITH THE HDMI CONNECTOR

- This unit is equipped with two HDMI digital inputs and one HDMI digital output.
- Use a commercially available HDMI connecting cable for connection.

■ Connections

- Connect a hard disc recorder, etc. equipped with an HDMI connector to the HDMI IN 1 connector on the unit.
The connected equipment is assigned to the H1 button on the supplied remote controller.
- Connect a video game console equipped with an HDMI connector to the HDMI IN 2 connector on the unit.

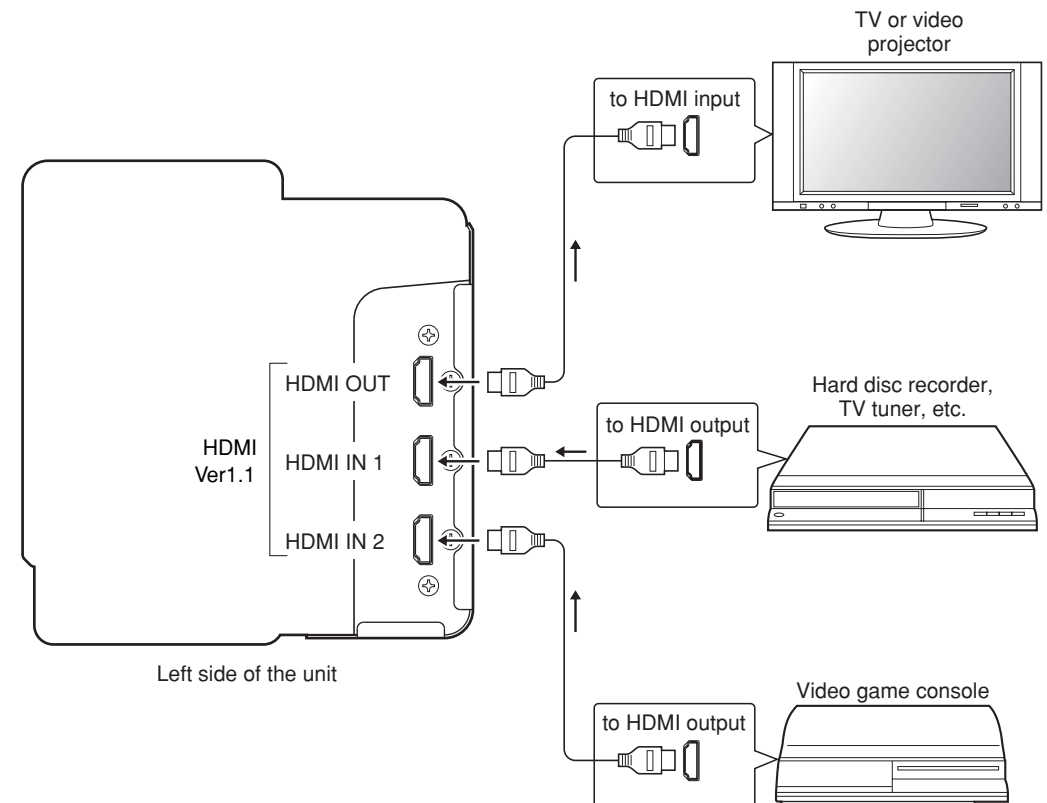

CONNECTIONS

CONNECTING A SUBWOOFER

- For connection with the optional SW7001 subwoofer, use the connecting cable supplied with the SW7001.
- If the power of the SW7001 is turned on after connection, it will be turned on or goes into standby mode in conjunction with the operations of the unit. This function is not available with other manufacturers' subwoofers.

■ Connections

- Connect the SUB W. PREOUT jack on the unit to the input jack on the SW7001.
- Connect the SUB W. CONTROL OUT jack on the unit to the control input jack on the SW7001.

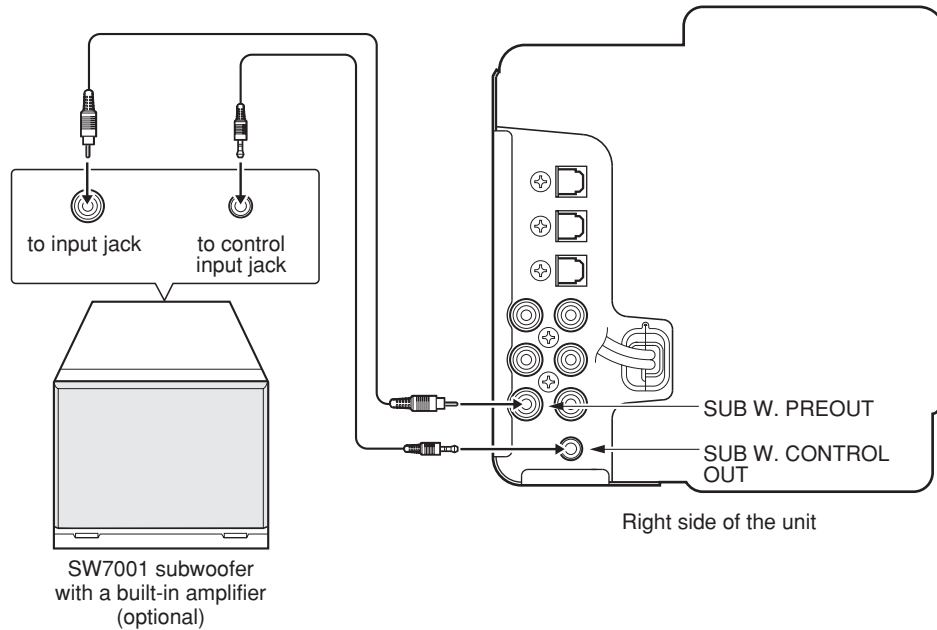

REMOTE CONTROL CONNECTIONS

- The REMOTE OUT jack is used for connection with the Marantz DVD player, etc. equipped with remote control output.
- When the Marantz DVD player or the IS201 is located in a place where the infrared beam cannot be easily received, make a remote control connection. When you operate the remote controller pointing toward this unit, a received command signal is transmitted to the connected equipment.

■ Connections

- Connect the Marantz DVD player to the REMOTE OUT jack on the unit using the remote control cable supplied with the player.

Note:

For this connection, set the remote control switch on the rear panel of the connected equipment to EXT.

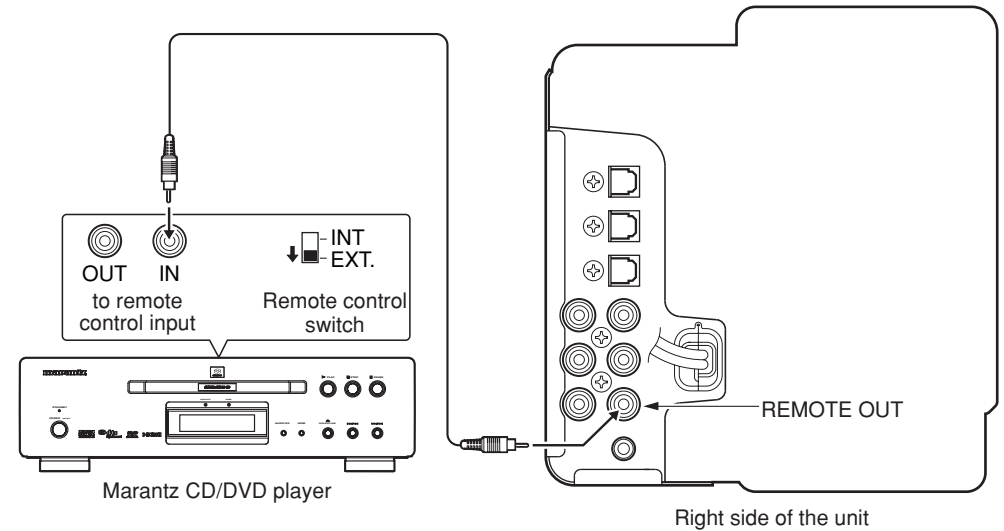

INSTALLATION

■ Installing the unit

- Install the unit so that the center of the seat is aligned with the center of the unit.

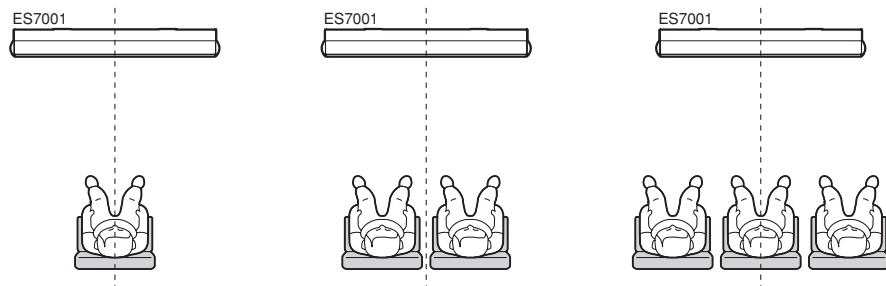

- When mounting the unit in a rack, align the front surface of the rack with the front of the unit.

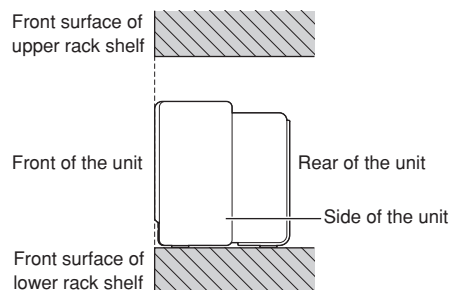

Notes:

- The unit weighs 12 kg. Use commercially available wires, etc. to take measures to prevent the unit from falling due to vibration caused by earthquake or mishandling by children.
- Do not place the unit on the surface of an object generating heat such as a CRT-based TV.
- If the TV picture is blurred, install the unit apart from the TV.

[To mount the unit in the optional AV rack]

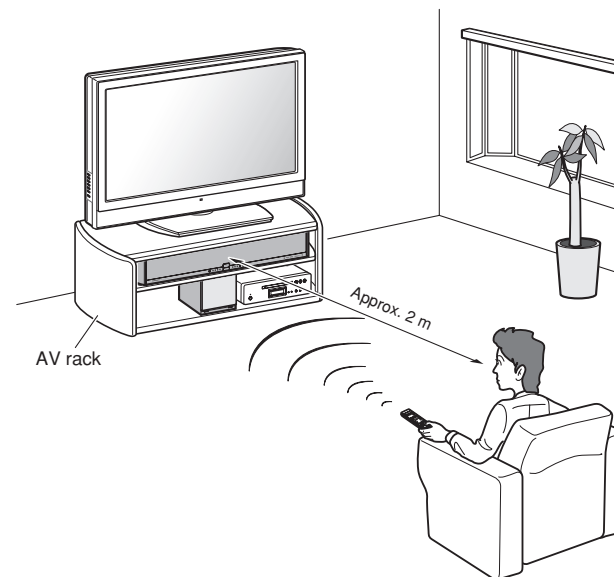

[To install the unit in a higher place than the connected TV]

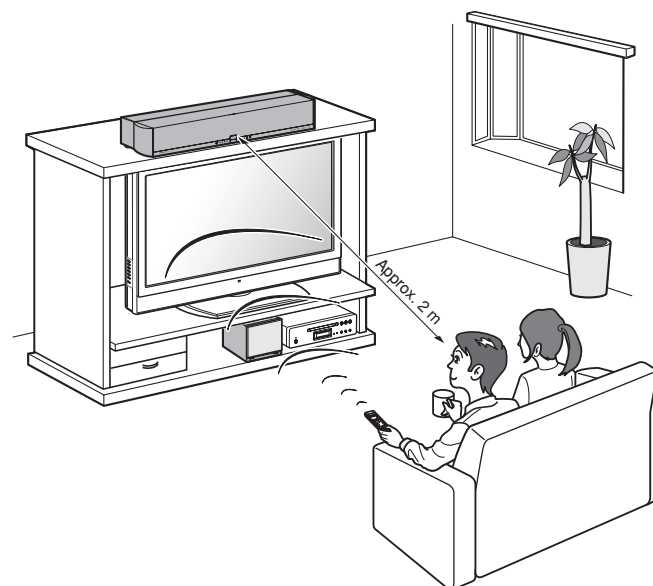

BASIC OPERATIONS

TURNING ON THE UNIT

1. Turn on the power of the audio equipment connected to this unit. Set the input selector on the audio equipment to this unit.
2. Connect the AC power cord to the wall outlet.
3. Press the POWER ON/STANDBY button on the unit or POWER button on the remote controller to turn on the power of the unit.
 - Each time the button is pressed, the power of the unit is switched between on and standby mode.

Auto-power-off function

- If the power of the connected DVD player, TV, video game console, etc. is turned off and the power of the unit remains on, the unit automatically goes into standby mode.
- If no signal is input to this unit for five minutes with the input selector set to "DVD," "TV" or "GAME," the unit automatically goes into standby mode.

PLAYING THE INPUT SOURCE

The procedure for operating the unit for playback with a DVD player is described below as a representative example.

Check that the DVD player and the unit are correctly connected, referring to "Connections" in this Guide.

■ To play a DVD disc with the DVD player

1. Turn on the power of the DVD player.
2. Press the POWER ON/STANDBY button ① on the unit or POWER button ① on the remote controller to turn on the unit.
3. Press the INPUT SELECT button ⑫ on the unit repeatedly to select "d1" or the d1 button of the input select buttons ② on the remote controller.
4. Load a disc into the DVD player and start playback.
5. Adjust the volume with the VOLUME +/- buttons ③/④ on the unit or the MAIN VOLUME +/- buttons ⑦/⑧ on the remote controller.

■ Muting function

Press the MUTE button ⑨ on the remote controller to mute the sound temporarily.

While the muting function is activated, the volume level indication flashes in the display window.

To restore the sound, press the MUTE button ⑨ or the MAIN VOLUME +/- buttons ⑦/⑧ on the remote controller, or the VOLUME +/- buttons ③/④ on the unit.

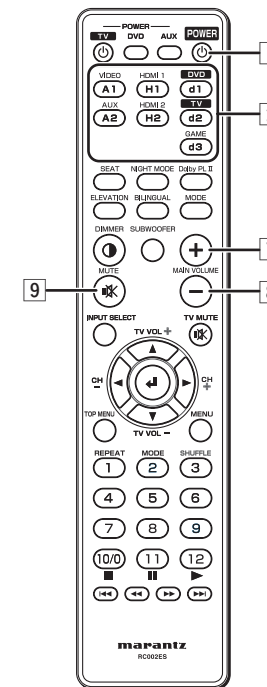
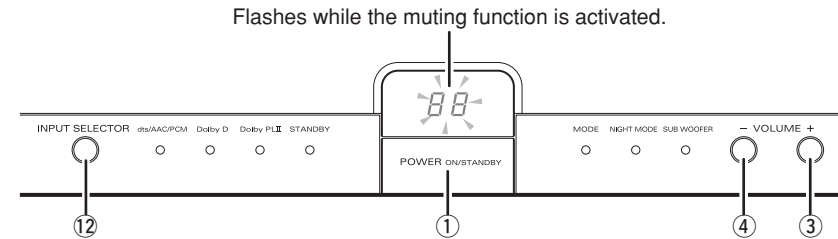

SETTINGS

The following setting items are available with this unit.

- Setting Installation Height of Speakers (page 17)
- Setting the number of audience (page 17)
- Setting the viewing/listening distance (page 18)
- Setting the subwoofer output (page 18)
- Setting the binaural mode (page 19)
- Setting the Dolby Pro Logic II (page 19)
- Mode setting multi-channel TV sound mode (page 20)
- Setting the night mode (page 20)
- Setting the dimmer (page 20)
- Resetting Items to factory preset settings (page 21)

SETTING INSTALLATION HEIGHT OF SPEAKERS

- This item is used to set the installation location (height) of the unit.
- Press the ELEVATION button on the remote controller to change the setting.
- Each time the button is pressed, the setting switches as described below.
- This item is set at the factory as if the unit is installed in a lower place than the connected TV (mounted on the upper shelf of the optional RM7001 AV).

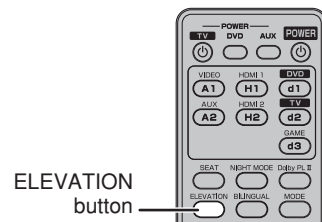
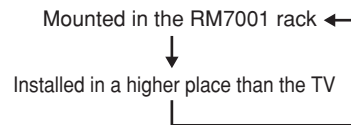

- When the unit is mounted in the RM7001 rack



- When the unit is installed in a higher place than the connected TV



SETTING THE NUMBER OF AUDIENCE

- This item is used to set whether you view/listen to the source input to this unit alone or with multiple persons in a room.
- Press the SEAT button on the remote controller to switch to “2 or more persons.”
- This item is set to “2 or more persons” at the factory.

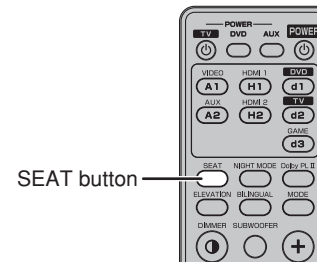

- When audience is one person



- When audience is two or more persons

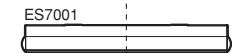

Note:

When there is a large audience, try both settings and select the setting which gives a better stereophonic effect.

SETTINGS

**SETTING THE VIEWING/
LISTENING DISTANCE**

- This item is used to set the distance between the unit and audience.

- Hold down the SEAT button on the remote controller for over two seconds to change the setting.

Each time you hold down the button for over two seconds while the viewing/listening distance indication is displayed in the display window, the setting switches as described below.

This item is set to “Approx. 2 m” at the factory.

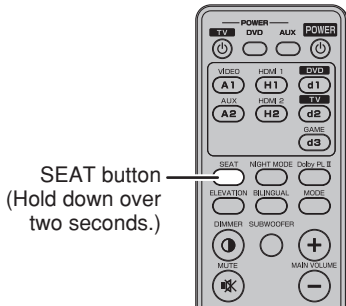

- When the distance is shorter than 2 m



- When the distance is approximately 2 m



- When the distance is longer than 2 m



Notes:

- When the audience is 2.5 m or farther away from the unit with the viewing/listening distance set to “2 m or longer,” the stereophonic effect of the speakers may be reduced.
- When the audience is close 1.5 m or less to the unit with the viewing/listening distance set to “2 m or shorter,” the stereophonic effect of the speakers may be reduced.

**SETTING THE
SUBWOOFER OUTPUT**

- Press the SUBWOOFER button on the remote controller when you use a commercially available or optional SW7001 subwoofer with a built-in amplifier so that the SUB WOOFER indicator lights. The subwoofer output is activated, enabling output of low-frequency sound from the connected subwoofer. The low-frequency sound from this unit is adjusted so that it does not overlap with that from the connected subwoofer.

- To turn off the subwoofer output, press the SUBWOOFER button on the remote controller once to display the “On” indication in the display window, then press it again while the indication is displayed.

The indication in the display window changes to “OF” and the SUB WOOFER indicator goes out. The subwoofer output is set to off and low-frequency sound of the unit is restored.

- This setting is set to “On” at the factory.

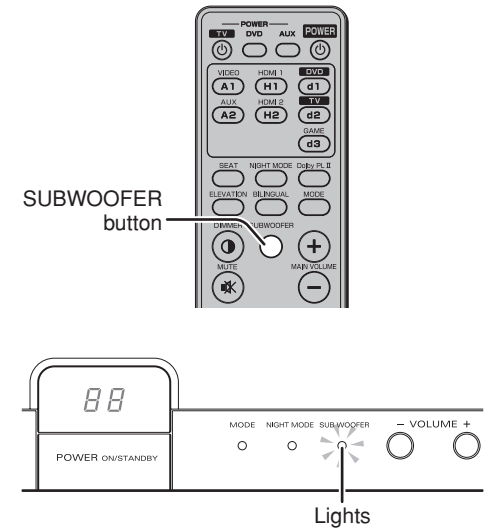

- When the subwoofer output is set to on



- When the subwoofer output is set to off



Notes

- Be sure to set the subwoofer output to off when you do not use an external subwoofer. Optimum low-frequency sound is only output from the speakers built in the unit with the subwoofer output set to off.
- You cannot adjust the volume level of the connected subwoofer with this unit. Adjust it with the connected subwoofer.

SETTINGS

SETTING THE BINAURAL MODE

- Press the MODE button on the remote controller to listen to the audio source recorded in binaural mode.
- The MODE indicator lights in blue and the stereophonic effect of the sound source is reproduced especially realistically.

Note:

The binaural mode is automatically canceled when a sound source other than 2-channel PCM sound or analog sound is input.

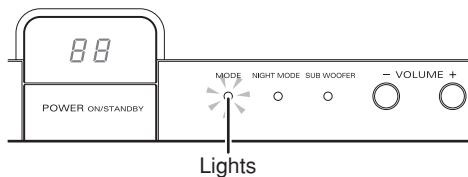
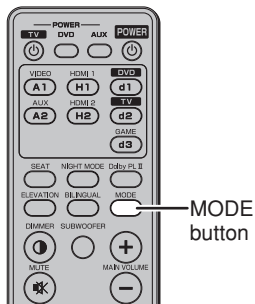

SETTING THE DOLBY PRO LOGIC II MODE

- This item is used to select the sound field environment produced by Dolby Pro Logic II.
- When the unit is set to "PL II MOVIE" or "PL II MUSIC," the Dolby PL II indicator lights.
- Each time you press the Dolby PL II button on the remote controller, the sound field setting changes as follows:

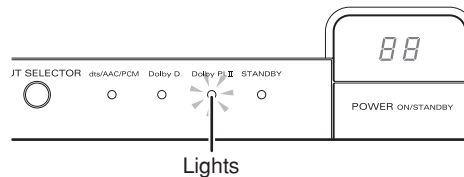
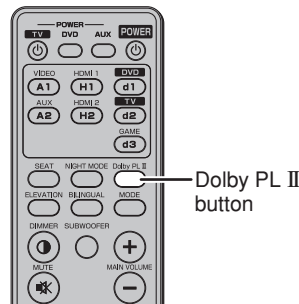

● When "PL II MOVIE" is selected



Stereophonic effect is obtained from the soundtrack of a stereo movie encoded by Dolby Surround.

● When "PL II MUSIC" is selected



Stereophonic effect is obtained from a conventional stereo source such as a CD player, iPod, etc.

● When "OFF" is selected



The Dolby Pro Logic II mode is turned off. If the signal source is input from the ANALOG IN 1 (VCR) or 2 (AUX) jacks, or 2-channel digital signal is input when the Dolby Pro Logic II mode is set to "PL II MOVIE" or "PL II MUSIC," the setting is automatically switched to "PL II MOVIE" and the Dolby PL II indicator lights.

Notes:

- To change the setting, press the Dolby PL II button repeatedly.
- The selected setting of Dolby Pro Logic II mode is saved in the unit.

SETTINGS

SETTING MULTI-CHANNEL TV SOUND MODE

- When the unit receives a high-definition broadcast (AAC signal), the AAC indicator lights in yellow.

In this case, you can select the output sound from the TV by pressing the BILINGUAL button on the remote controller.

- Each press of the button changes the sound as follows:

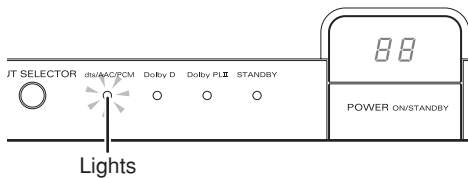
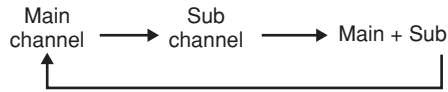

- When “Main channel” is selected



- When “Sub channel” is selected



- When “Main+Sub” is selected



Note:

Some broadcasts may not feature multi-channel audio (AAC signal).

SETTING THE NIGHT MODE

This mode is convenient for enjoying a movie, etc. at night. You can enjoy the playback sound without elevating the entire volume as only the enhanced parts of the sound are suppressed in this mode. Press the NIGHT MODE button on the remote controller to activate this mode. The NIGHT MODE indicator lights in green on the unit.

The night mode is only available when the Dolby Digital indicator is lit in blue.

Note:

Since the night mode effect is set by the Dolby digital software, the desired effect may not be achieved with software that does not support the Dolby digital signal. This mode cannot be used when a dts, AAC or PCM signal is input.

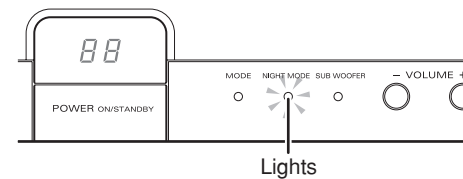
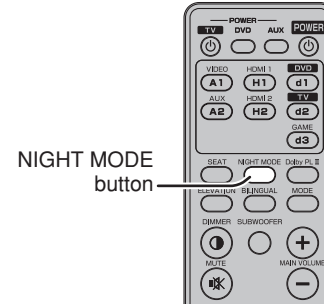

SETTING THE DIMMER

Press the DIMMER button on the remote controller to dim the display window of the unit. To cancel the dimmer mode, press the button again.

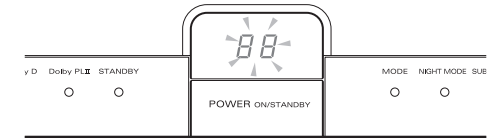
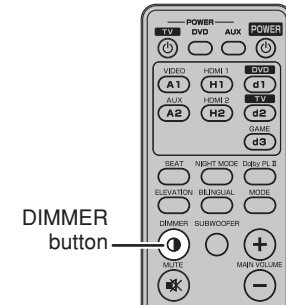

SETTINGS

RESETTING ITEMS TO FACTORY PRESET SETTINGS

To reset all the items that have been set to the factory preset settings (initial settings), hold down the POWER ON/STANDBY button and VOLUME + button on the unit simultaneously for over 3 seconds while the power of the unit is on.

After two seconds, the unit goes into standby mode, turns on again, then the settings are reset to their factory preset ones.

Initial settings of unit

Power ON
 Input selector DVD
 Display window volume level indication
 Volume level 00

Initial settings of setting items

Speaker installation height L
 (installed in a lower place than the connected TV)
 Number of audience2P (2 or more persons)
 Viewing/listening distance -- (2 m)
 Subwoofer .. On (subwoofer output activated)
 Binaural mode off
 Dolby PL II P1 (PL II MOVIE)
 Multi-channel broadcastb1 (main channel)
 Night mode off
 Dimmer normal brightness
 Muting off

TROUBLESHOOTING

Before considering it as a failure

In case of trouble with this component, first check the following before calling for service.

What seems to be a serious malfunction is often due to a simple operation mistake.

If the trouble is not fixed after making the following checks, contact the place of purchase, your nearest Marantz dealer, our customer service center, or our repair service center.

Power does not turn on.

1. Is the power cord inserted into the wall outlet securely?
 → Plug in the power cord securely.
2. Is the STANDBY indicator lit?
 → Press the POWER button on the remote controller.

No sound is heard from the speakers.

1. Is input source selection with the INPUT SELECTOR buttons on the front panel correct?
 → Check that the input source is selected correctly.
2. Are you operating the playback equipment correctly?
 → Refer to the instruction manual supplied with the playback equipment.
3. Are the connecting cables between the unit and the playback equipment correctly connected?
 → Connect the connecting cables correctly.
4. Is the muting function deactivated?
 → Set the muting function to off.

Noises appear while the CD or LD that contains dts signal is played.

1. Is the playback equipment not connected to the ANALOG IN jacks on the unit?
 → Check that the playback equipment is equipped with digital output, and connect it to the digital input on this unit.
2. Does the CD or LD support the dts signal output?
 → Refer to the instruction manual supplied with the playback equipment.

96 kHz PCM signal cannot be played.

1. This unit is compatible with 32 kHz, 44.1 kHz and 48 kHz sampling frequencies.
 → Downsample the DVD player audio to 48 kHz.

About the Protective Circuit

This unit incorporates a protective circuit that protects the amplifier circuits and speaker system against damage.

As soon as the protective circuit works, the unit goes into standby mode and the STANDBY indicator flashes at the same time.

For power-on

For 3 or 4 seconds after the power of the unit is turned on the protective circuit works and the sound is muted. Once the amplifier circuits are stabilized, the protective circuit is released and the sound is restored.

For heat-up of the power amplifier

When the power amplifier of the unit heats up under the following conditions, the protective circuit works and the unit goes into the standby mode.

- The unit is kept used with excessive signal input, and the temperature of the main amplifier section exceeds the set operating temperature.
- Since the ventilation holes at the rear of the unit are blocked or the unit is installed in a narrow rack, the internal temperature of the unit exceeds the set operating temperature.

In this case, wait until the temperature is sufficiently lowered, then turn on the unit and operate it at a lower volume.

SPECIFICATIONS

● Audio power amplifier

Rated power output (20 Hz-20 kHz / THD = 0.05%)
.....26 W/ch 6Ω

Maximum power output (1 kHz/JEITA)
.....30 W/ch 6Ω

Frequency characteristics

Analog input: ANALOG IN 1

.....20 Hz-20 kHz (± 3 dB)

Digital input: PCM 44.1 kHz

.....20 Hz-20 kHz (± 3 dB)

S/N ratio: PCM 44.1 kHz

.....100 dB

● Decoding

Compatible playback signal formats

PCM audio (fs = 32 kHz, 44.1 kHz, 48 kHz)

DOLBY DIGITAL

dts

AAC

Binaural

● Power supply

Power requirements..... AC 220 V, 50 Hz

Power consumption 40 W
..... 125 W (6Ω, 30 W x 2 outputs)

Power consumption in standby mode... 0.8 W

● Input

OPT IN (optical digital)3 inputs

HDMI IN (Version 1.1)2 inputs

ANALOG IN 2 inputs (stereo)

● Output

HDMI OUT (Version 1.1) 1 output

SUB W. PREOUT 1 output

REMOTE OUT..... 1 output

● Speakers

Tweeter 1.9 cm dome x 2

Midrange..... 8 cm cone x 2

Woofer 12 cm cone x 2

● Dimensions (unit)

Width 1,080 mm

Height 153 mm

Depth 144 mm

Mass (unit).....12 kg

● Supplied accessories

Remote controller 1

AAA batteries 2

User Guide (this manual)..... 1

Note:

The speaker nets cannot be removed.

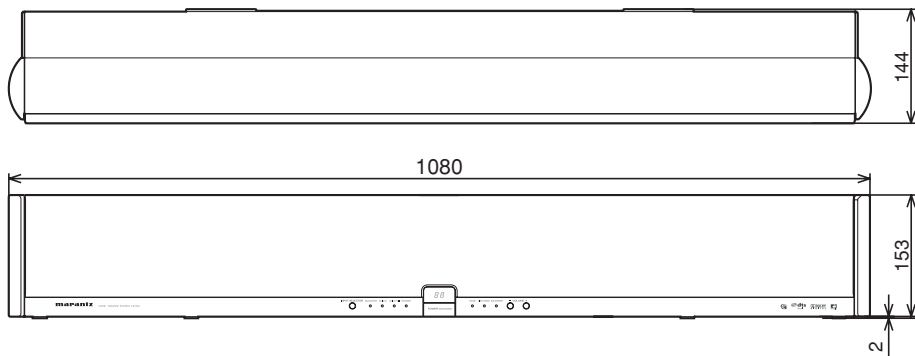

Specifications subject to change without prior notice.

OTHERS

The section describes the care and maintenance tasks that must be performed to optimize the operation of your Marantz component.

■ Cleaning of equipment external surfaces

The exterior finish of your unit will last indefinitely with proper care and cleaning. Never use scouring pads, steel wool, scouring powders or harsh chemical agents (e.g., lye solution), alcohol, thinner, benzine, insecticide or other volatile substances as these will mar the finish of the equipment. Likewise, never use cloths containing chemical substances. If the equipment get dirty, wipe the external surfaces with a soft, lint-free cloth.

If the equipment becomes heavily soiled:

- dilute some washing up liquid in water, in a ratio of one part detergent to six parts water.
- dip a soft, lint free in the solution and wring the it is damp.
- wipe the equipment with the damp cloth.
- dry the equipment by wiping it with a dry cloth.



■ Repairs

Only the most competent and qualified service technicians should be allowed to service the factory-trained warranty station personnel have the knowledge and special facilities needed for repair and calibration of this precision equipment. After the warranty period has expired, repairs will be performed for a charge if the equipment can be returned to normal operation.

In the event of difficulty, refer to your dealer or write directly to the nearest location to you that is listed on the Marantz Authorized Service Station list. If writing, please include the model and serial number of the equipment together with a full description of what you think is abnormal about the equipment's behaviour.

www.marantz.com.cn

You can find your nearest authorized distributor or dealer on our website.

marantz[®] is a registered trademark.

Marantz Brand Company, D&M Holdings Inc.